

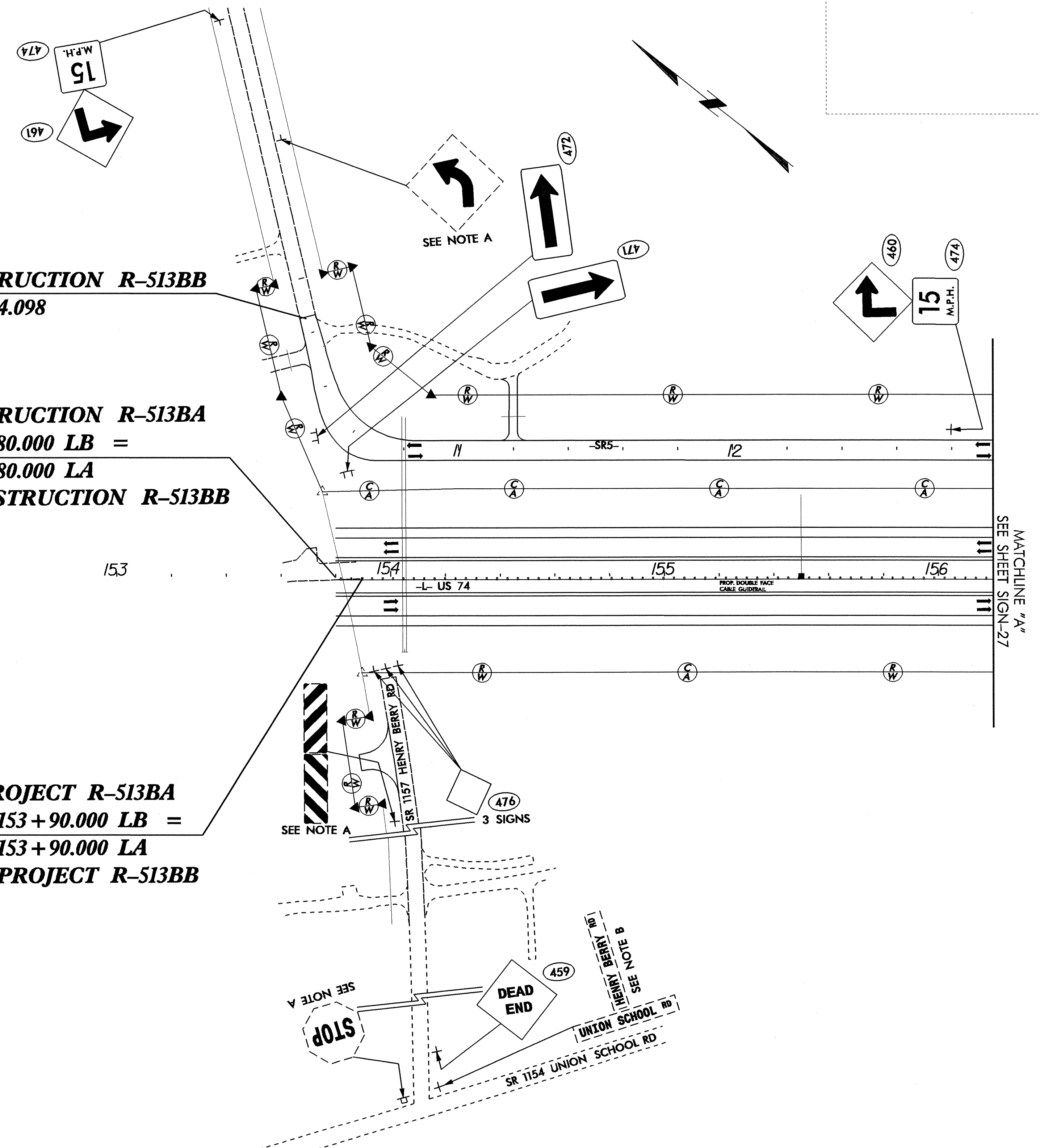

**BEGIN CONSTRUCTION R-513BB**  
-SR5- Sta. 10+14.098

**END CONSTRUCTION R-513BA**  
-L- Sta. 153+80.000 LB =  
-L- Sta. 153+80.000 LA  
**BEGIN CONSTRUCTION R-513BB**

**END PROJECT R-513BA**  
-L- Sta. 153+90.000 LB =  
-L- Sta. 153+90.000 LA  
**BEGIN PROJECT R-513BB**



MATCHLINE "A"  
SEE SHEET SIGN-27

**SIGNS FURNISHED BY STATE**  
**ALL SIGNS SHALL BE FIELD LOCATED BY THE ENGINEER**

SYMBOLS
* TRAFFIC SIGNAL LOCATION. NOTE: REMOVE AND DISPOSE OF ALL EXISTING SIGNS UNLESS OTHERWISE NOTED

**PBS&J** 1616 EAST MILLBROOK ROAD, SUITE 310  
RALEIGH, NORTH CAROLINA 27609  
PHONE: (919) 876-6888

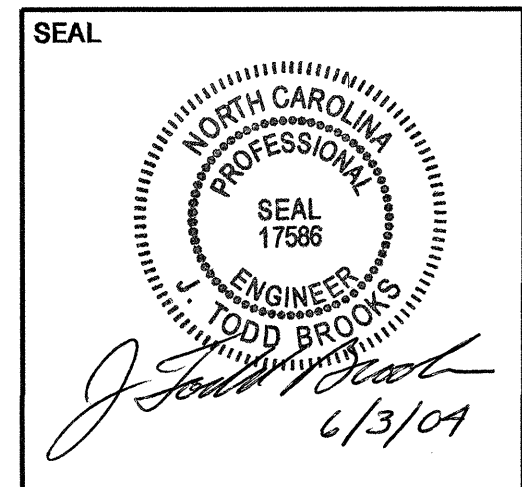

EXISTING AND PROPOSED SIGNS		STA 153+90 to STA 156+20 -L-		I-74 / US 74	
SCALE	1:1000	N. C. DEPARTMENT OF TRANSPORTATION		REVISIONS	
DATE	JUNE 2004	DIVISION OF HIGHWAYS			
SIGNING TECHNICIAN	JAWEMH	TRAFFIC ENGINEERING BRANCH			
SIGNING DESIGN ENG	LM MOON				
SIGNING PROJECT ENG	JT BROOKS				

03-JUN-2004 17:20 C:\EG\CURR\260219\_50\_0513\0513BB\0513BB\0513BB.dwg