



STATE OF NORTH CAROLINA
DEPARTMENT OF TRANSPORTATION

BEVERLY EAVES PERDUE
GOVERNOR

EUGENE A. CONTI, JR.
SECRETARY

January 28, 2011

Addendum No. 1

RE: Contract ID C202591

WBS # 35196.3.18, 35196.3.19

F. A. # NHF-0100(18), NHF-0100(19)

Cumberland County (X-0002BC & X-0002CA) Proposal No. 1

I-295 (Fayetteville Outer Loop) From NC-87/210 (Murchison Road)
to SR-1600 (McArthur Road)

February 15, 2011

To Whom It May Concern:

Reference is made to the plans and proposal furnished to you on this project.

The following revision has been made to the Structure plans:

On Sheet No. S-4 the "Total Bill of Materials" was revised to correct the quantity of "Visual Barrier Wall On Structure". Please void Sheet No. S-4 in your plans and staple the revised Sheet No. S-4 thereto.

The following revisions have been made to the Proposal:

New Page Nos. 92A and 92B have been added to include the project special provisions entitled "Flaggers" and "Automated Machine Guidance". Please staple new Page Nos. 92A and 92B after Page No. 92 in your proposal.

New Page Nos. 338 thru 359 have been added to include a 404 and 401 permit modification. Please staple New Page Nos. 338 thru 359 after Page No. 337.

The second page of the Table of Contents has been revised to reflect the above noted change. Please void the second page of the Table of Contents in your proposal and staple the revised page thereto.

MAILING ADDRESS:

NC DEPARTMENT OF TRANSPORTATION
CONTRACT STANDARDS AND DEVELOPMENT UNIT
1591 MAIL SERVICE CENTER
RALEIGH NC 27699-1591

TELEPHONE: 919-250-4128

FAX: 919-250-4119

WEBSITE: WWW.NCDOT.ORG

LOCATION:

CENTURY CENTER COMPLEX
ENTRANCE B-2
1020 BIRCH RIDGE DRIVE
RALEIGH NC 27610

On Page No. 16 of the item sheets the following pay item quantity has been revised.

<u>Item</u>	<u>Description</u>	<u>Old Quantity</u>	<u>New Quantity</u>
256-8893000000-M-SP	Visual Barrier Wall On Structure	281.811 M2	207.225 M2

The Contractor's bid must be based on this revised pay item quantity. The contract will be prepared accordingly.

The Expedite File has been updated to reflect this revision. Please download the Expedite Addendum File and follow the instructions for applying the addendum. Bid Express will not accept your bid unless the addendum has been applied.

Sincerely,

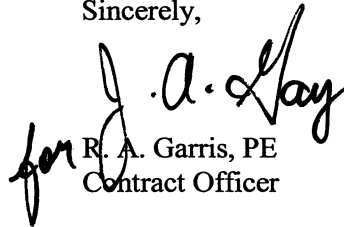
R. A. Garris, PE
Contract Officer

RAG/jag

Attachments

cc: Mr. Jon Nance, PE
Mr. Ron Hancock, PE
Mr. G. W. Burns, PE
Ms. D. M. Barbour, PE
Mr. Art McMillan, PE
Mr. J. V. Barbour, PE
Ms. Lori Strickland
Mr. John Sullivan (FHWA) Attn: Mr. Jake Riggsbee, PE
Project File (2)

Mr. R.E. Davenport, PE
Ms. Natalie Roskam, PE
Mr. Njoroge Wainaina, PE
Mr. G. R. Perfetti, PE
Mr. Larry Strickland
Mr. Ronnie Higgins

FLAGGERS:

(2-15-11)

M11 R20

Revise the 2006 Metric Standard Specifications as follows:

Page 11-10, Article 1150-3 Construction Methods, replace the article with the following:

Provide the service of properly equipped and qualified flaggers (see *Roadway Standard Drawing* 1150.01) at locations and times for such period as necessary for the control and protection of vehicular and pedestrian traffic. Anyone who controls traffic is required to be qualified. Qualification consists of each flagger receiving proper training in the set-up and techniques of safely and competently performing a flagging operation. Qualification of flaggers is to be done at an NCDOT approved training agency. For a complete listing of these, see the Work Zone Traffic Control's webpage, <http://www.ncdot.gov/doh/preconstruct/wztc/>.

Prior to beginning work on the project, a Qualification Statement that all flaggers used on the project have been properly trained through an NCDOT approved training resource shall be provided to the Engineer.

Flagging operations are not allowed for the convenience of the Contractor's operations. However, if safety issues exist (i.e. sight/stopping site distance), the Engineer may approve the use of flagging operations. Use flagging methods that comply with the guidelines in the MUTCD.

AUTOMATED MACHINE GUIDANCE:

01-02-11

GENERAL

This Special Provision contains requirements to be followed if the Contractor elects to use Global Positioning System (GPS) machine control grading and shall be used in conjunction with Section 801 of the Standard Specifications for Roads and Structures. The use of this technology is referenced as Automated Machine Guidance (AMG).

All equipment using AMG shall be able to generate end results that meet the Standard Specifications. Perform test sections for each type of work to be completed with AMG to demonstrate that the system has the capability to achieve acceptable results. If acceptable results can not be achieved, conform to the requirements for conventional stakeout.

The Contractor shall be responsible for all errors resulting from the use of AMG and shall correct deficiencies to the satisfaction of the Engineer at no cost to the Department.

SUBMITTALS

If the Contractor elects to use AMG, a Digital Terrain Model (DTM) of the design surface and all intermediate surfaces shall be developed and submitted to the Engineer for review.

At least 90 days prior to beginning grading operations, the Contractor shall submit to the Engineer an AMG work plan to include, but not limited to, proposed equipment, control

software manufacturer and version, types of work to be completed using AMG, project site calibration report, repetitive calibration methods for construction equipment and rover units to be used for the duration of the project, and local GPS base station to be used for broadcasting differential correction data to rover units (this may include the NC Network RTK). All surveys must be tied to existing project control as established by NCDOT.

INSPECTION

The Engineer will perform quality assurance checks of all work associated with AMG. If it is determined that work is not being performed in a manner that will assure accurate results, the Engineer may require corrective action at no cost to the Department.

The Contractor shall provide the Engineer with one GPS rover unit for use during the duration of the contract. The rover will be loaded with the same model that is used with the AMG and have the same capability as rover units used by the Contractor. The rover will be kept in the possession of the Engineer and will be returned to the Contractor upon completion of the contract. Any maintenance or repairs required for the rover will be the responsibility of the Contractor. Formal training of at least 8 hours shall be provided to the Engineer by the Contractor on the use of the proposed AMG system.

SUBGRADE AND BASE CONTROLS

If the Contractor elects to use AMG for fine grading and placement of base or other roadway materials, the GPS shall be supplemented with a laser or robotic total station. Include details of the proposed system in the AMG work plan. In addition, the following requirements apply for the use of AMG for subgrade and base construction.

1. Provide control points at intervals along the project not to exceed 1000 feet. The horizontal position of these points shall be determined by static GPS sessions or by traverse connection from the original base line control points. The elevation of these control points shall be established using differential leveling from project benchmarks, forming closed loops where practical. A copy of all new control point information shall be provided to the Engineer prior to construction activities.
2. Provide control points and conventional survey grade stakes at 500' intervals and at critical points such as, but not limited to, PCs, PTs, superelevation transition points, and other critical points as requested by the Engineer.
3. Provide hubs at the top of the finished subgrade at all hinge points on the cross section at 500 foot intervals. These hubs shall be established using conventional survey methods for use by the Engineer to check the accuracy of construction.

MEASUREMENT AND PAYMENT

No direct payment will be made for work required to utilize this provision. All work will be considered incidental to various grading operations.



REPLY TO
ATTENTION OF:

338

DEPARTMENT OF THE ARMY
WILMINGTON DISTRICT, CORPS OF ENGINEERS
69 DARLINGTON AVENUE
WILMINGTON, NORTH CAROLINA 28403-1343

December 21, 2010

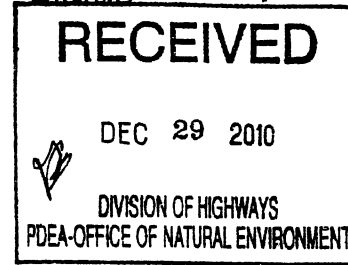

Regulatory Division

Subject: Action ID No. 2008-01413, TIP No. U-2519 and X-0002, Fayetteville Outer Loop, Cumberland, Robeson and Hoke Counties, North Carolina.

Dr. Gregory J. Thorpe, Ph.D.
Environmental Management Director
Project Development and Environmental Analysis
1598 Mail Service Center
Raleigh, North Carolina 27699-1598

Dear Dr. Thorpe:

I am responding to your requests dated June 1, 2010 and October 19, 2010 for modifications to the existing Department of the Army (DA) permit issued for the above referenced project on November 4, 2008.

The referenced Section 404 permit authorizes impacts to 48.43 acres of jurisdictional wetlands, 12,346 linear feet of important stream channel and 3.67 acres of open waters. The permit modification is proposed to include additional impacts that were not authorized by the November 4, 2008 Department of the Army permit. The project impacts proposed in the modification request include an additional 0.43 acres of wetland impacts, 410 linear feet of important stream channel impacts and 2.55 acres of open water pond impacts.

I have determined that the proposed project modifications described above are minor and are not contrary to the public interest and therefore, the DA permit is hereby modified. It is understood that all conditions of the original permit remain applicable and that the expiration date is unchanged

The permit modifications are as follows:

1. In order to compensate for impacts to 0.43 acres of riparian, non-riverine wetlands and 410 linear feet of warm-water stream, the permittee shall debit the Privateer Farms Stream and Wetland Mitigation Bank in the amount of 1.29 acres of restoration equivalent riparian, non-riverine wetlands and 615 linear feet of warm-water stream.

In accordance with the NC DOT Umbrella Mitigation Banking Instrument dated September 4, 2009, the permittee shall, within 30-days of the date of this permit

modification, provide two copies of the current debit ledger of the Privateer Farms Stream and Wetland Mitigation Bank to the :

**U.S. Army Corps of Engineers
Wilmington Regulatory Field Office
69 Darlington Avenue, Wilmington North Carolina 28403**

2. All work authorized by this permit modification must be performed in strict compliance with the attached plans, which are part of the permit.

Should you have any questions, please contact Mr. Ronnie Smith, Wilmington Field Office, Regulatory Division, at telephone (910) 251-4829.

Sincerely,

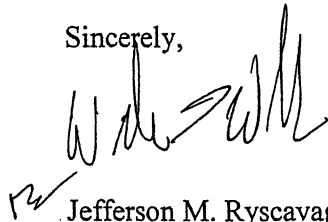

Jefferson M. Ryscavage
Colonel, U.S. Army
District Commander

Enclosures

Copies Furnished (with enclosures):

Mr. Greg Burns, PE
Division Engineer, Division 6
N.C. Department of Transportation
Post Office Box 1150
Fayetteville, North Carolina 28302

Mr. Jim Rerko
Division Environmental Officer, Division 6
N.C. Department of Transportation
Post Office Box 1150
Fayetteville, North Carolina 28302

Pace Wilber, Ph.D., Chief
Charleston (F/SER47)
Southeast Regional Office, NOAA Fisheries
Post Office Box 12559
Charleston, South Carolina 29422-2559

U.S. Fish and Wildlife Service
Fish and Wildlife Enhancement
Post Office Box 33726
Raleigh, North Carolina 27636-3726

Mr. Ron Sechler •
National Marine Fisheries Service
Pivers Island
Beaufort, North Carolina 28516

Mr. Doug Huggett
Division of Coastal Management
N.C. Department of Environment
and Natural Resources
400 Commerce Avenue
Morehead City, North Carolina 28557

Copies Furnished (without enclosures):

Mr. Travis W. Wilson
N.C. Wildlife Resource Commission
1142 I-85 Service Road
Creedmoor, North Carolina 27522

Mr. Mason Herndon
N.C. Department of Environment
and Natural Resources
Division of Water Quality
225 Green Street, Suite 214
Fayetteville, North Carolina 28301-5094

Mr. Gary Jordan
U.S. Fish and Wildlife Service
Raleigh Field Office
Post Office Box 33726
Raleigh, North Carolina 27636-3726

Mr. Chris Militcher
U.S. Environmental Protection Agency
c/o Federal Highway Administration
310 New Bern Avenue, Room 206
Raleigh, North Carolina 27601

Ms. Renee Gledhill-Early
N.C. Department of Cultural Resources
4617 Mail Service Center
Raleigh, North Carolina 27699



North Carolina Department of Environment and Natural Resources

Division of Water Quality
Coleen H. Sullins
Director

Beverly Eaves Perdue
Governor

Slanton

Dee Freeman
Secretary

December 16, 2010

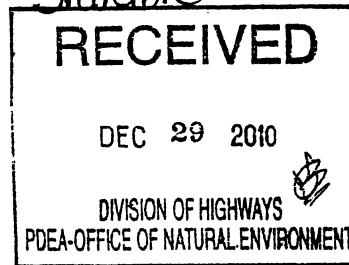

Dr. Greg Thorpe, PhD., Manager
Project Development and Environmental Analysis
North Carolina Department of Transportation
1548 Mail Service Center
Raleigh, North Carolina, 27699-1548

Subject: Modification to the 401 Water Quality Certification Pursuant to Section 401 of the Federal Clean Water Act with ADDITIONAL CONDITIONS for Proposed improvements to Fayetteville Outer Loop in Cumberland, Hoke and Robeson County, Federal Aid Project No. NHF-DPR-0100(001), State Project No. 8.244130, TIP X-002 B & C and U-2519.
NCDWQ Project No. 20080737 v. 3

Dear Dr. Thorpe:

Attached hereto is a modification of original Certification No. 3758 issued to The North Carolina Department of Transportation (NCDOT) dated October 6, 2008 and modification dated June 3, 2010.

If we can be of further assistance, do not hesitate to contact us.

Sincerely,

Behinda L. Hanson

for Coleen H. Sullins
Director

Attachments

- cc: Ronnie Smith, US Army Corps of Engineers, Wilmington Field Office
- Greg Burns, PE, Division 6 Engineer
- Jim Rerko, Division 6 Environmental Officer
- Chris Militscher, Environmental Protection Agency (electronic copy only)
- Travis Wilson, NC Wildlife Resources Commission
- Leilani Paugh, NCDOT, NEU Mitigation
- Sonia Carrillo, NCDWQ Central Office
- File Copy

225 Green St., Suite 714, Fayetteville, NC 28301-5043
Phone: 910-433-3300 \ FAX: 910-486-0707
Internet: www.ncwaterquality.org

One
North Carolina
Naturally

Modification to the 401 Water Quality Certification Pursuant to Section 401 of the Federal Clean Water Act with ADDITIONAL CONDITIONS

THIS CERTIFICATION is issued in conformity with the requirements of Section 401 Public Laws 92-500 and 95-217 of the United States and subject to the North Carolina Division of Water Quality (NCDWQ) Regulations in 15 NCAC 2H .0500. This certification modification authorizes the NCDOT to impact an additional 0.19 acres of jurisdictional wetlands and 410 linear feet of jurisdictional streams in Cumberland County. The project shall be constructed pursuant to the modification dated received October 14, 2010. The new authorized impacts are as described below:

Revised X-0002C (Site 8) Stream Impacts in the Cape Fear River Basin

Site	Permanent Fill in Intermittent Stream (linear ft)	Temporary Fill in Intermittent Stream (linear ft)	Permanent Fill in Perennial Stream (linear ft)	Temporary Fill in Perennial Stream (linear ft)	Total Stream Impact (linear ft)	Stream Impacts Requiring Mitigation (linear ft)
Original approved impacts at Site 8	509				509	
New additional impacts with this approval at Site 8	410				410	410
Total	919				919	410

Revised Total Stream Impact for Site 8: 919 linear feet

Revised X-0002C (Site 8) Wetland Impacts in the Cape Fear River Basin (non-riverine)

Site	Fill (ac)	Fill (temporary) (ac)	Excavation (ac)	Mechanized Clearing (ac)	Hand Clearing (ac)	Area under Bridge (ac)	Total Wetland Impact (ac)
Original approved impacts at Site 8	0.09			0.04	0.21		0.13
New revised impacts with this approval at Site 8	0.29			0.03	0.00		0.32
Total	0.29			0.03	0.00		0.32

Revised Total Wetland Impact for Site 8: 0.32 acres.

The application provides adequate assurance that the discharge of fill material into the waters of the Cape Fear River Basin in conjunction with the proposed development will not result in a violation of applicable Water Quality Standards and discharge guidelines. Therefore, the State of North Carolina certifies that this activity will not violate the applicable portions of Sections 301, 302, 303, 306, 307 of PL 92-500 and PL 95-217 if conducted in accordance with the application and conditions hereinafter set forth.

This approval is only valid for the purpose and design that you submitted in your modified application dated received October 14, 2010. All the authorized activities and conditions of certification associated with the original Water Quality Certification dated October 6, 2008 and modification dated June 3, 2010 still apply except where superseded by this certification. Should your project change, you are required to notify NCDWQ and submit a new application. If the property is sold, the new owner must be given a copy of this Certification and approval letter, and is thereby responsible for complying with all the conditions. If any additional wetland impacts, or stream impacts, for this project (now or in the future) exceed one acre or 150 linear feet, respectively, additional compensatory mitigation may be required as described in 15A NCAC 2H .0506 (h) (6) and (7). For this approval to remain valid, you are required to comply with all the conditions listed below. In addition, you should obtain all other federal, state or local permits before proceeding with your project including (but not limited to) Sediment and Erosion control, Coastal Stormwater, Non-discharge and Water Supply watershed regulations. This Certification shall expire on the same day as the expiration date of the corresponding Corps of Engineers Permit.

Condition(s) of Certification:

343

1. Compensatory mitigation for the additional 0.19 acres of wetland impacts is required at a 2:1 ratio. Compensatory mitigation for the additional 410 feet of stream impacts is required at 1.5:1 ratio. We understand that you have chosen to debit mitigation from Privateer Farm Mitigation Bank. This certification gives you approval to debit 0.38 acres of wetland mitigation and 615 ft of stream mitigation from the Privateer Mitigation Site to satisfy the mitigation requirements of this permit modification.
2. All other conditions written into previous Water Quality Certifications dated October 6, 2008 and June 3, 2010 for this project still apply.

Violations of any condition herein set forth may result in revocation of this Certification and may result in criminal and/or civil penalties. This Certification shall become null and void unless the above conditions are made conditions of the Federal 404 and/or Coastal Area Management Act Permit. This Certification shall expire upon the expiration of the 404 or CAMA permit.

If you wish to contest any statement in the attached Certification you must file a petition for an administrative hearing. You may obtain the petition form from the office of Administrative hearings. You must file the petition with the office of Administrative Hearings within sixty (60) days of receipt of this notice. A petition is considered filed when it is received in the office of Administrative Hearings during normal office hours. The Office of Administrative Hearings accepts filings Monday through Friday between the hours of 8:00am and 5:00pm, except for official state holidays. The original and one (1) copy of the petition must be filed with the Office of Administrative Hearings.

The petition may be faxed-provided the original and one copy of the document is received by the Office of Administrative Hearings within five (5) business days following the faxed transmission. The mailing address for the Office of Administrative Hearings is:

Office of Administrative Hearings
6714 Mail Service Center
Raleigh, NC 27699-6714
Telephone: (919)-733-2698, Facsimile: (919)-733-3478

A copy of the petition must also be served on DENR as follows:

Ms. Mary Penny Thompson, General Counsel
Department of Environment and Natural Resources
1601 Mail Service Center
Raleigh, NC 27699-1601

This the 16th day of December 2010

DIVISION OF WATER QUALITY

Coleen H. Sullins
Director



North Carolina Department of Environment and Natural Resources

Beverly Eaves Perdue
Governor

Division of Water Quality
Coleen H. Sullins
Director

Stanton

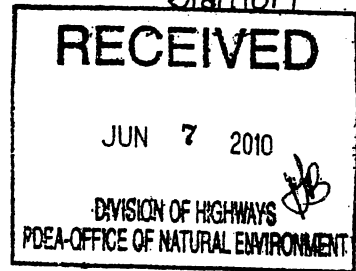

Dee Freeman
Secretary

June 3, 2010

Dr. Greg Thorpe, PhD., Manager
Project Development and Environmental Analysis
North Carolina Department of Transportation
1548 Mail Service Center
Raleigh, North Carolina, 27699-1548

Subject: Modification to the 401 Water Quality Certification Pursuant to Section 401 of the Federal Clean Water with ADDITIONAL CONDITIONS for Proposed Fayetteville Outer Loop in Cumberland, Hoke and Robeson Counties, Federal Aid Project No. NHF-DPR-0100(001), State Project No. 8.2441301, TIP Nos. X-002 B&C and U-2519.
DWQ Project No. 20080737 ver. 2.

Dear Dr. Thorpe:

Attached hereto is a modification of Certification No. 3758 issued to The North Carolina Department of Transportation (NCDOT) originally dated October 6, 2008.

If we can be of further assistance, do not hesitate to contact us.

Sincerely,

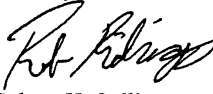
for Coleen H. Sullins
Director

Attachments

cc: Tom Walker, US Army Corps of Engineers, Wilmington Field Office
Jim Rerko, Division 6 Environmental Officer
LeiLani Paugh, NCDOT NEU
NCDWQ Fayetteville Regional Office
File Copy

Transportation Permitting Unit
1650 Mail Service Center Raleigh, North Carolina 27699-1650
Location: 2321 Crabtree Blvd., Raleigh, North Carolina 27604
Phone: 919-733-1786 FAX: 919-733-6893
Internet: <http://h2o.enr.state.nc.us/ncewetlands/>

One
North Carolina
Naturally

Modification to the 401 Water Quality Certification Pursuant to Section 401 of the Federal Clean Water Act with ADDITIONAL CONDITIONS

THIS CERTIFICATION is issued in conformity with the requirements of Section 401 Public Laws 92-500 and 95-217 of the United States and subject to the North Carolina Division of Water Quality (NCDWQ) Regulations in 15 NCAC 2H .0500. This certification modification authorizes the NCDOT to impact an additional 0.24 acres of jurisdictional wetlands in Cumberland County. The project shall be constructed pursuant to the modification dated received May 27, 2010. The new authorized impacts are as described below:

Additional Section X-002 C Wetland Impacts in the Cape Fear River Basin

Site	Permanent Fill (ac)	Excavation (ac)	Mechanized Clearing (ac)	Total Wetland Impact (ac)
10	0.19	0.01	0.04	0.24
Total	0.19	0.01	0.04	0.24

Total Additional Wetland Impact for Section X-002 C: 0.24 acres.

Revised Section X-002 C Open Water (Ponds) Impacts in the Cape Fear River Basin

Site	Permanent Fill in Open Waters (ac)
3	0.73
9	2.53
Total	3.26

Revised Total Open Water Impact for Section X-002 C: 3.26 acres.

The application provides adequate assurance that the discharge of fill material into the waters of the Cape Fear River Basin in conjunction with the proposed development will not result in a violation of applicable Water Quality Standards and discharge guidelines. Therefore, the State of North Carolina certifies that this activity will not violate the applicable portions of Sections 301, 302, 303, 306, 307 of PL 92-500 and PL 95-217 if conducted in accordance with the application and conditions hereinafter set forth.

This approval is only valid for the purpose and design that you submitted in your modified application dated received May 27, 2010. All the authorized activities and conditions of certification associated with the original Water Quality Certification dated October 6, 2008 still apply except where superceded by this certification. Should your project change, you are required to notify NCDWQ and submit a new application. If the property is sold, the new owner must be given a copy of this Certification and approval letter, and is thereby responsible for complying with all the conditions. If any additional wetland impacts, or stream impacts, for this project (now or in the future) exceed one acre or 150 linear feet, respectively, additional compensatory mitigation may be required as described in 15A NCAC 2H .0506 (h) (6) and (7). For this approval to remain valid, you are required to comply with all the conditions listed below. In addition, you should obtain all other federal, state or local permits before proceeding with your project including (but not limited to) Sediment and Erosion control, Coastal Stormwater, Non-discharge and Water Supply watershed regulations. This Certification shall expire on the same day as the expiration date of the corresponding Corps of Engineers Permit.

Conditions of Certification:

1. Compensatory mitigation for 0.24 acres of wetlands is required at a 2:1 ratio. We understand that you have chosen to debit mitigation from the Privateer Farm Mitigation Bank. This certification gives approval to the debiting of 0.48 acres of wetland mitigation from the Privateer Farms Mitigation Site in order to satisfy the mitigation requirements of this project modification.
2. All other conditions written into previous Water Quality Certification dated October 6, 2008 for this project still apply.

Violations of any condition herein set forth may result in revocation of this Certification and may result in criminal and/or civil penalties. This Certification shall become null and void unless the above conditions are made conditions of the Federal 404 and/or Coastal Area Management Act Permit. This Certification shall expire upon the expiration of the 404 or CAMA permit.

If this Certification is unacceptable to you have the right to an adjudicatory hearing upon written request within sixty (60) days following receipt of this Certification. This request must be in the form of a written petition conforming to Chapter 150B of the North Carolina General Statutes and filed with the Office of Administrative Hearings, 6714 Mail Service Center, Raleigh, N.C. 27699-6714. If modifications are made to an original Certification, you have the right to an adjudicatory hearing on the modifications upon written request within sixty (60) days following receipt of the Certification. Unless such demands are made, this Certification shall be final and binding.

This the 3rd day of June 2010

DIVISION OF WATER QUALITY



for Coleen H. Sullins
Director

WQC No. 3758

WETLAND PERMIT IMPACT SUMMARY

Site No.	Station (From/To)	Structure Size / Type	WETLAND IMPACTS					SURFACE WATER IMPACTS					
			Permanent Fill in Wetlands (ac)	Temp. Fill in Wetlands (ac)	Excavation in Wetlands (ac)	Mechanized Clearing in Wetlands (ac)	Hand Clearing in Wetlands (ac)	Permanent SW impacts (ac)	Temp. SW impacts (ac)	Existing Channel Impacts Permanent (ft)	Natural Stream Design - (ft)		
1	83+50-85+00 -L-	72" RCP	1.11		0.03	0.10			0.04			279	
2	92+90-93+80 -L-	42" RCP	0.50		0.02	0.08							
3	105+15-105+70 -L-	2 @ 6' x 7' RCBC	0.76			0.05			0.86			775	
4	117+95-118+70 -L-	325' Bridge	0.36			0.08		0.55					
5	129+60-130+20 -L-	54" RCP	0.69			0.06			0.02			361	
6	135+55-137+00 -L-	60" RCP	1.68			0.09			0.04			479	
7	141+30-142+30 -L-	36" RCP	1.55			0.05			0.01			213	
8	144+45-144+90 -L-	48" RCP	0.29			0.03			0.11			919	
9	14+20 -Y-Rev	2 @ 6' x 7' RCBC							2.54			98	
10	13+66-14+06 -Y1-	48" RCP	0.19		0.01	0.04			0.01			207	
TOTALS:			7.12		0.06	0.59		0.55	3.63			3332	

SITE 10: LATERAL EFFECT ON WETLAND DUE TO EXCAVATION = 0.01 ac

FILL IN SURFACE WATERS (POND)

SITE 3: 0.73 ac

SITE 9: 2.53 ac

NC DEPARTMENT OF TRANSPORTATION
DIVISION OF HIGHWAYS

CUMBERLAND COUNTY
WBS - 35196.1.2 (X-0002C)

SHEET **REV. 7/28/2010**

Permit Drawing
Sheet 3 of 64

TIP PROJECT: X-002C **CONTRACT: C201979**

See Sheet 1-A For Index of Sheets
See Sheet 1-B For Conventional Symbols

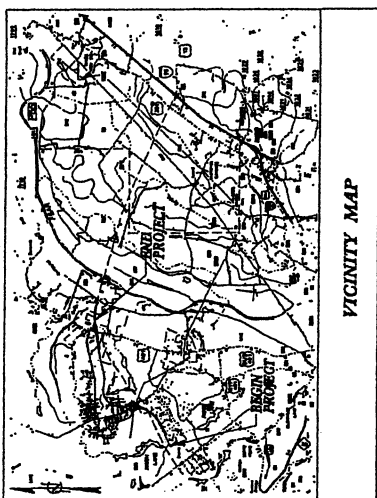

STATE OF NORTH CAROLINA
DIVISION OF HIGHWAYS

CUMBERLAND COUNTY

LOCATION: NC 24 EXTENSION (FAYETTEVILLE OUTER LOOP)
FROM 1.3 MILES EAST OF NC87-NC210 TO WEST OF US401

TYPE OF WORK: GRADING, DRAINAGE, PAVING, STRUCTURES,
SIGNING AND SIGNALS

STATE	N.C.	PROJECT NUMBER	X-002C
DATE	1	ROW & UTIL. CONST.	
DESIGNER	35176.1.2	ROW & UTIL. CONST.	
CONTRACTOR	35176.2.4	ROW & UTIL. CONST.	
PERMIT NUMBER	35176.3.16	ROW & UTIL. CONST.	

ALL DIMENSIONS IN METERS
THESE PLANS ARE IN METERS

WETLAND/STREAM IMPACTS

Permit Drawing Rev. 4/17/10
Sheet 9 of 10

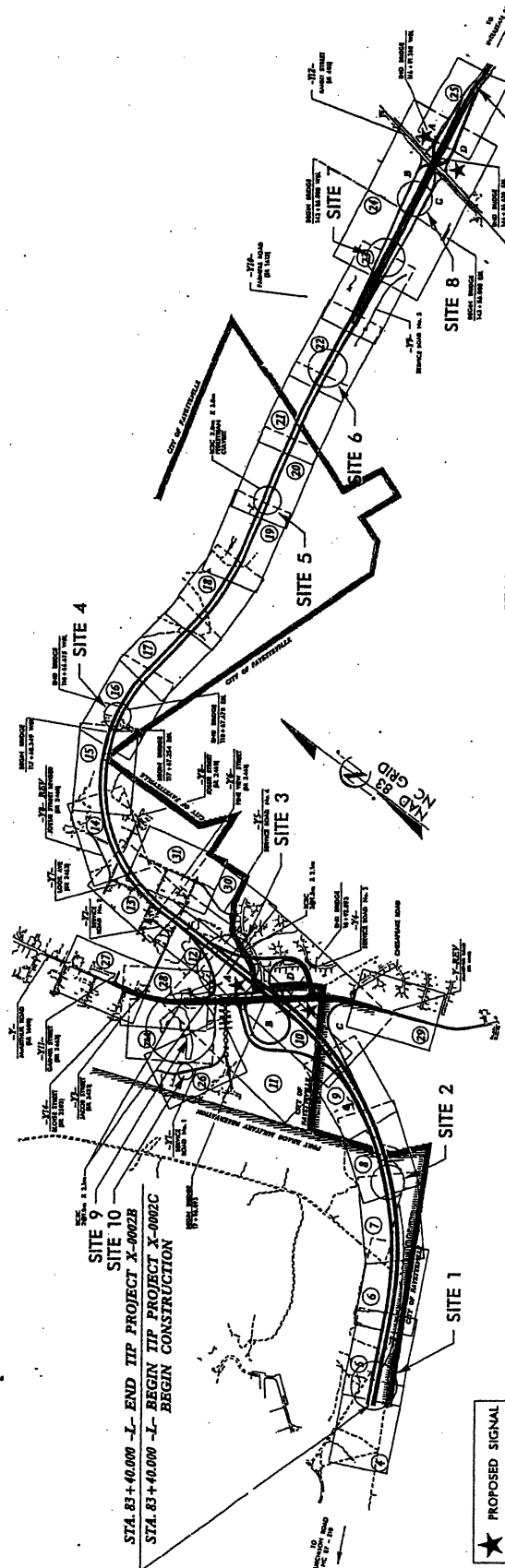

GRAPHIC SCALES

PLANS	0 10
PROFILE (HORIZONTAL)	0 10
PROFILE (VERTICAL)	0 2

DESIGN DATA

ADT 2008	= 34,700
ADT 2030	= 59,600
DIV	= 9 %
D	= 55 %
T	= 10 %
V	= 110 km/h

* (TTST 4 % DUAL 6 %) FUNC. CLASS = INTERSTATE

PROJECT LENGTH

LENGTH ROADWAY TIP PROJECT X-002C	= 6.166 km
LENGTH STRUCTURES TIP PROJECT X-002C	= 0.404 km*
TOTAL LENGTH OF TIP PROJECT X-002C	= 6.570 km

* NOTE: LENGTH BASED ON WBL BRIDGES

RIGHT OF WAY DATE: MAY 31, 2006

LETTING DATE: NOVEMBER 18, 2008

J.R. REID, P.E. PROJECT MANAGER

J.E. HUFFMAN, P.E. PROJECT DESIGN ENGINEER

Prepared in the Office of:
MORFITT & NICHOL
1000 W. HARRIS STREET - SUITE 100 - RALEIGH, NC 27601
919-873-1100 FAX - 919-873-1111

ROADWAY DESIGN ENGINEER
MORFITT & NICHOL

PRELIMINARY PLANS
INCOME TAX DEDUCTIBLE
IF YOU USE FOR P.T. PURPOSES

HYDRAULICS ENGINEER
SDC

DIVISION OF HIGHWAYS
STATE OF NORTH CAROLINA

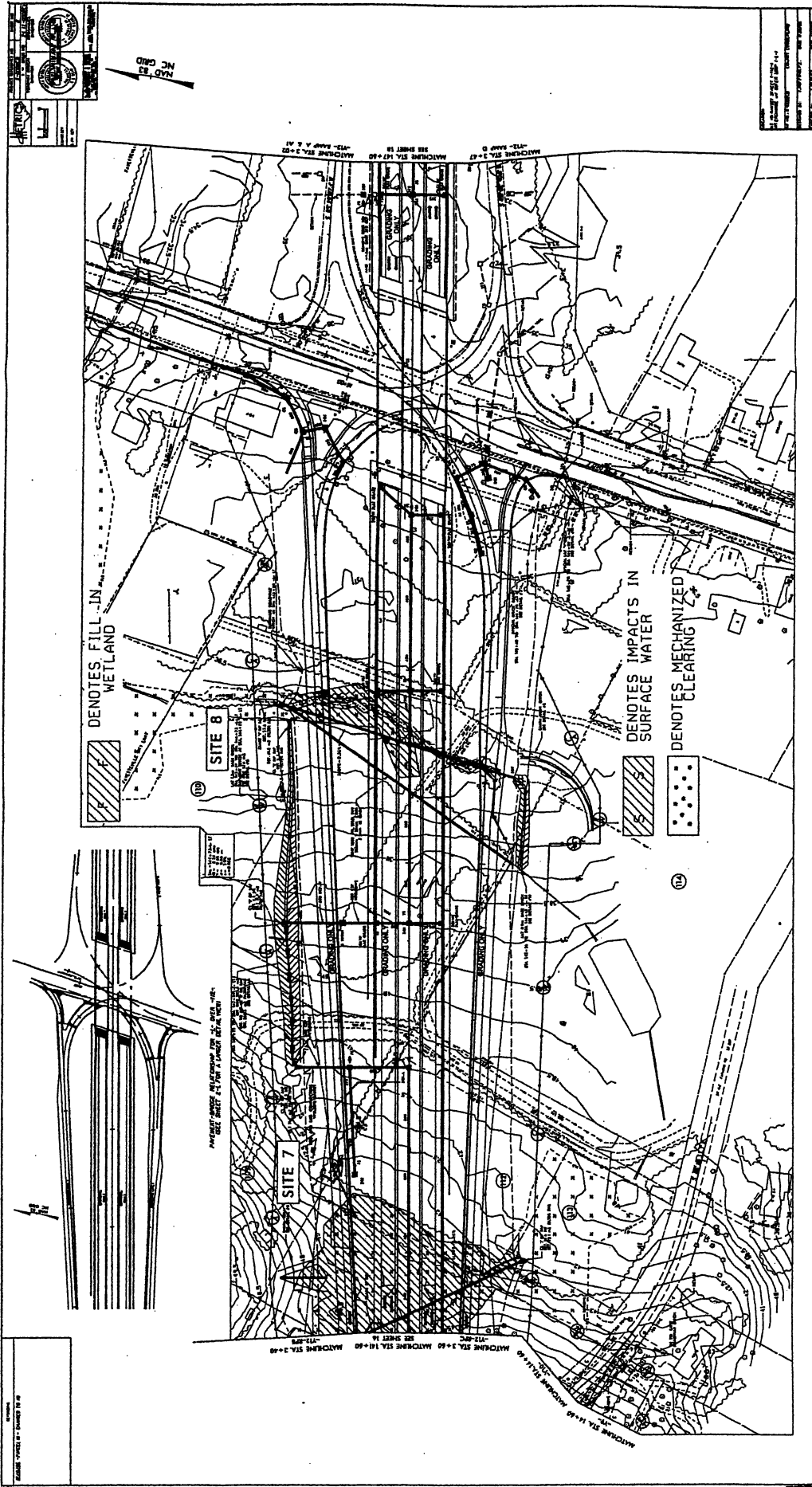

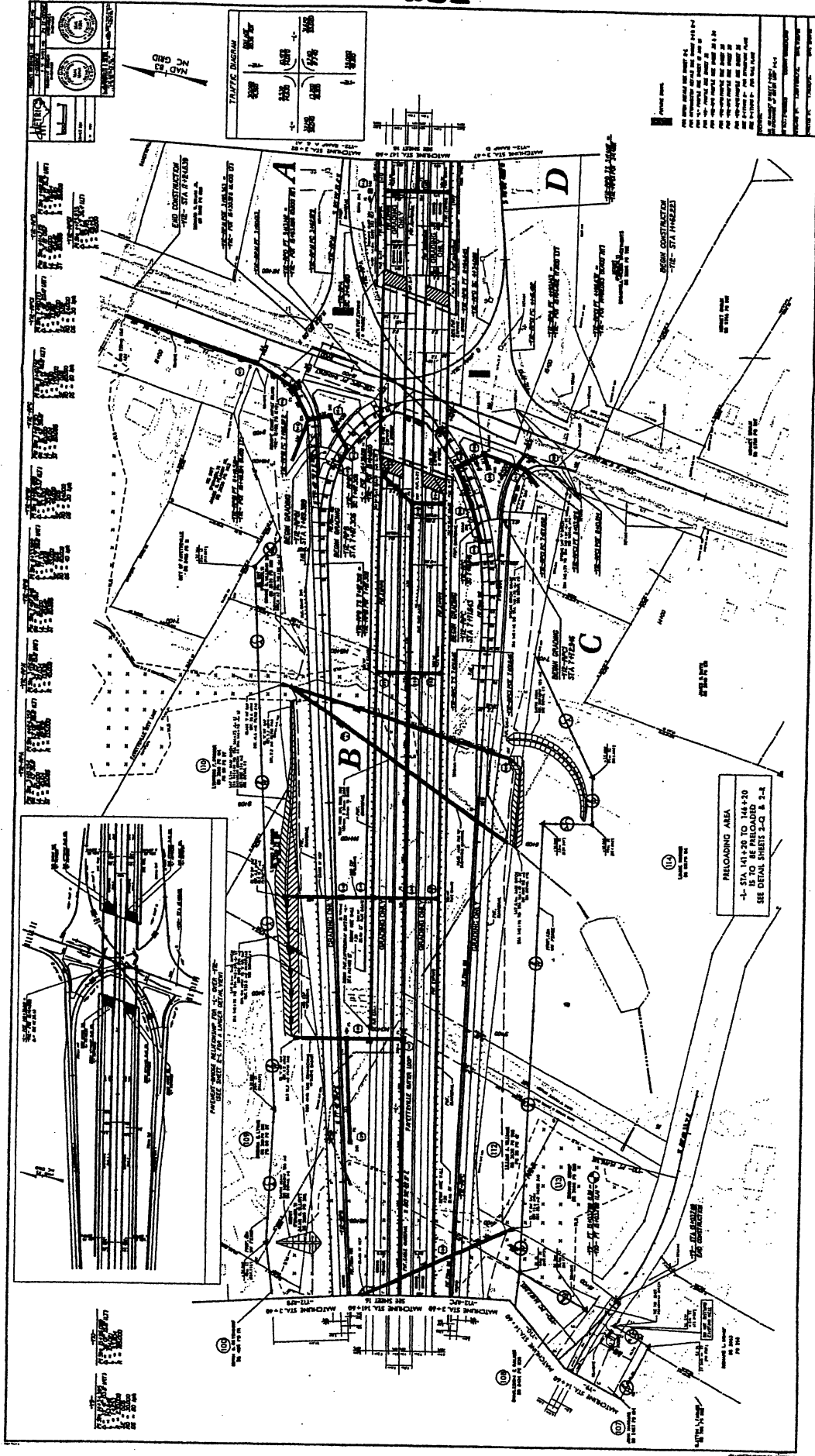

PROJECT REFERENCE NO. 1-1002AC
 SHEET NO. 28
 ROADWAY DESIGN ENGINEER
 METRICS
 CONST. DIV.
 ROADWAY DESIGN ENGINEER
 METRICS
 CONST. DIV.

Permit Drawing Ref. 417410
 Sheet 23 of 64

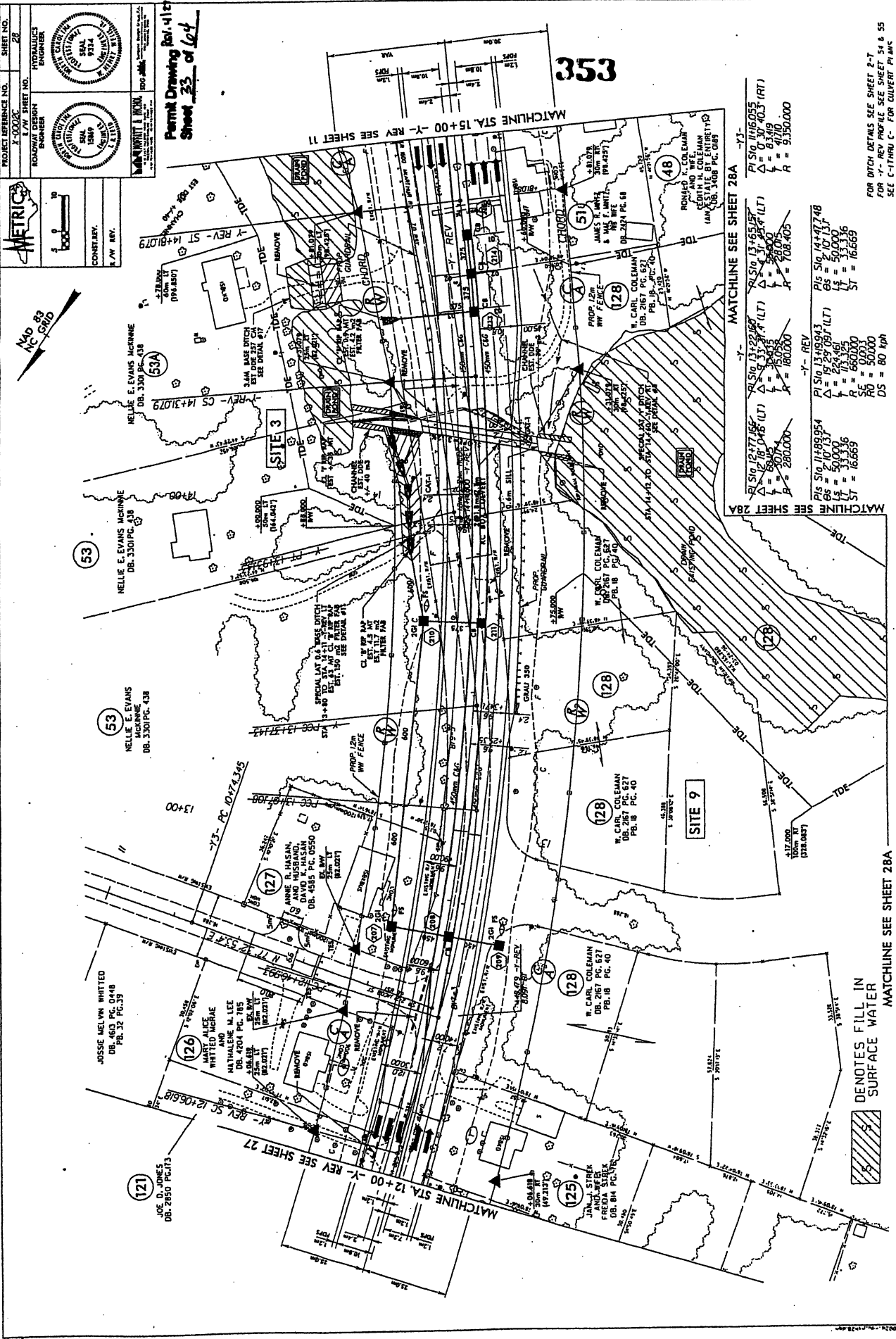

353

MATCHLINE SEE SHEET 28A

PLS 510 12177.185	PLS 510 13129.057	PLS 510 13155.057	PLS 510 13155.057
L = 121.77	L = 31.29	L = 31.29	L = 31.29
E = 16.048 (LT)	E = 17.924 (LT)	E = 17.924 (LT)	E = 17.924 (LT)
R = 280.000	R = 180.000	R = 180.000	R = 180.000
-Y- REV	-Y- REV	-Y- REV	-Y- REV
PLS 510 11899.954	PLS 510 13199.954	PLS 510 14147.748	
L = 118.95	L = 131.99	L = 141.47	
E = 50.000	E = 50.000	E = 50.000	
P = 13.336	P = 13.336	P = 13.336	
SE = 60.000	SE = 60.000	SE = 60.000	
RO = 50.000	RO = 50.000	RO = 50.000	
DS = 80 kph	DS = 80 kph	DS = 80 kph	

MATCHLINE SEE SHEET 28A



FOR DITCH DETAILS SEE SHEET 2-7
 FOR -Y- REV PROFILE SEE SHEET 54 & 55
 SEE C-11THRU C- FOR CONVEY P/MS

METRICS

PROJECT REFERENCE NO. X-0002C
 1/4" SHEET NO. 22A
 ROADWAY DESIGN ENGINEER

HYDRAULIC ENGINEER

SEAL 1549

SEAL 1549

SEAL 1549

SEAL 1549

CONST. DIV.
 E/W REV.

Rev. 1/12/16
 Permit Drawing
 Sheet 33R of 64

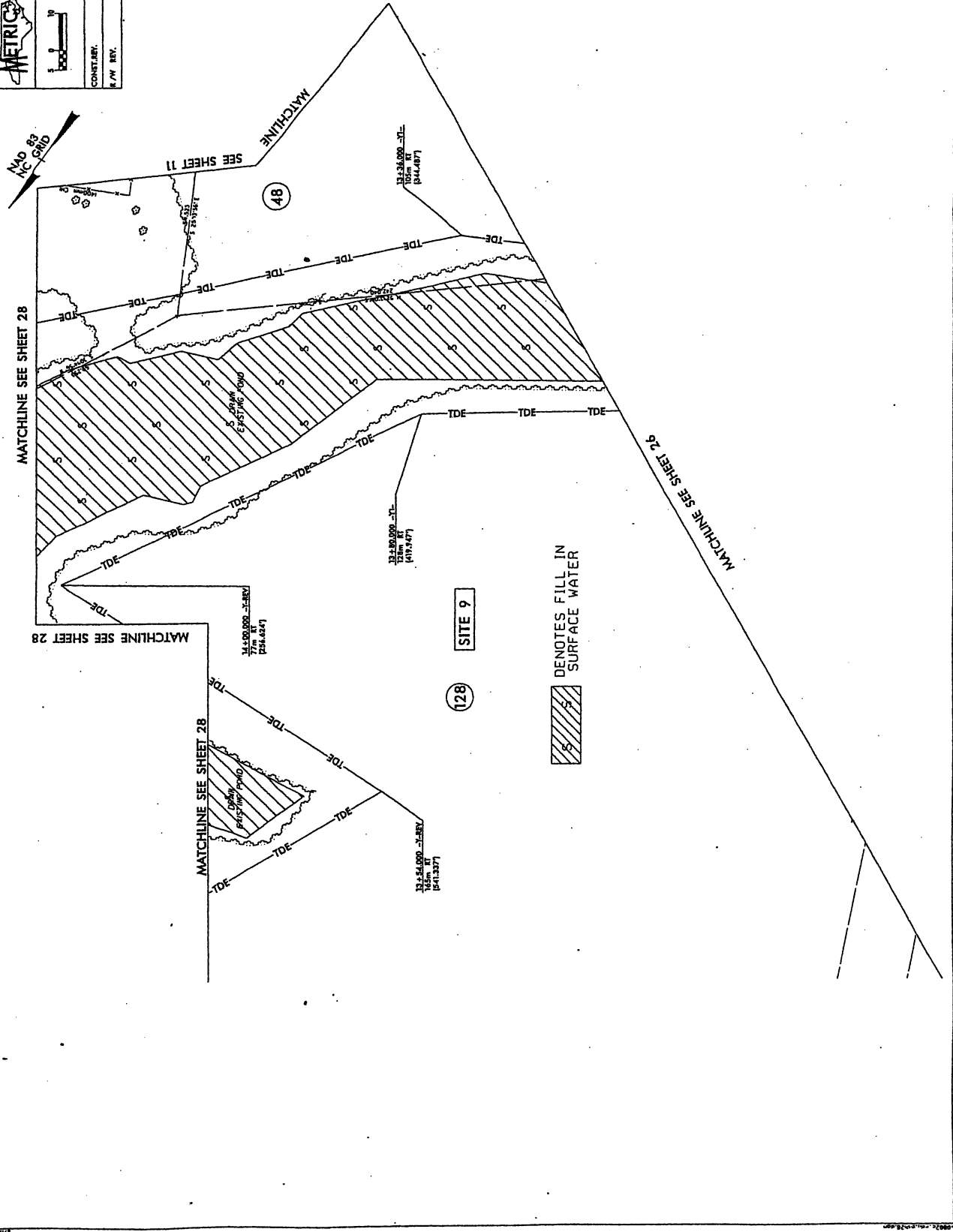

PROJECT REFERENCE NO. 7-0000C
 SHEET NO. 25
 DRAWING NUMBER
 CONTRACTOR
 P/W REV.

**Permk Drawing 01-11-14
 Sheet 23B of 104**

DENOTES FILL IN SURFACE WATER
 DENOTES FILL IN WETLAND
 DENOTES EXCAVATION IN WETLAND
 DENOTES MECHANIZED CLEARING

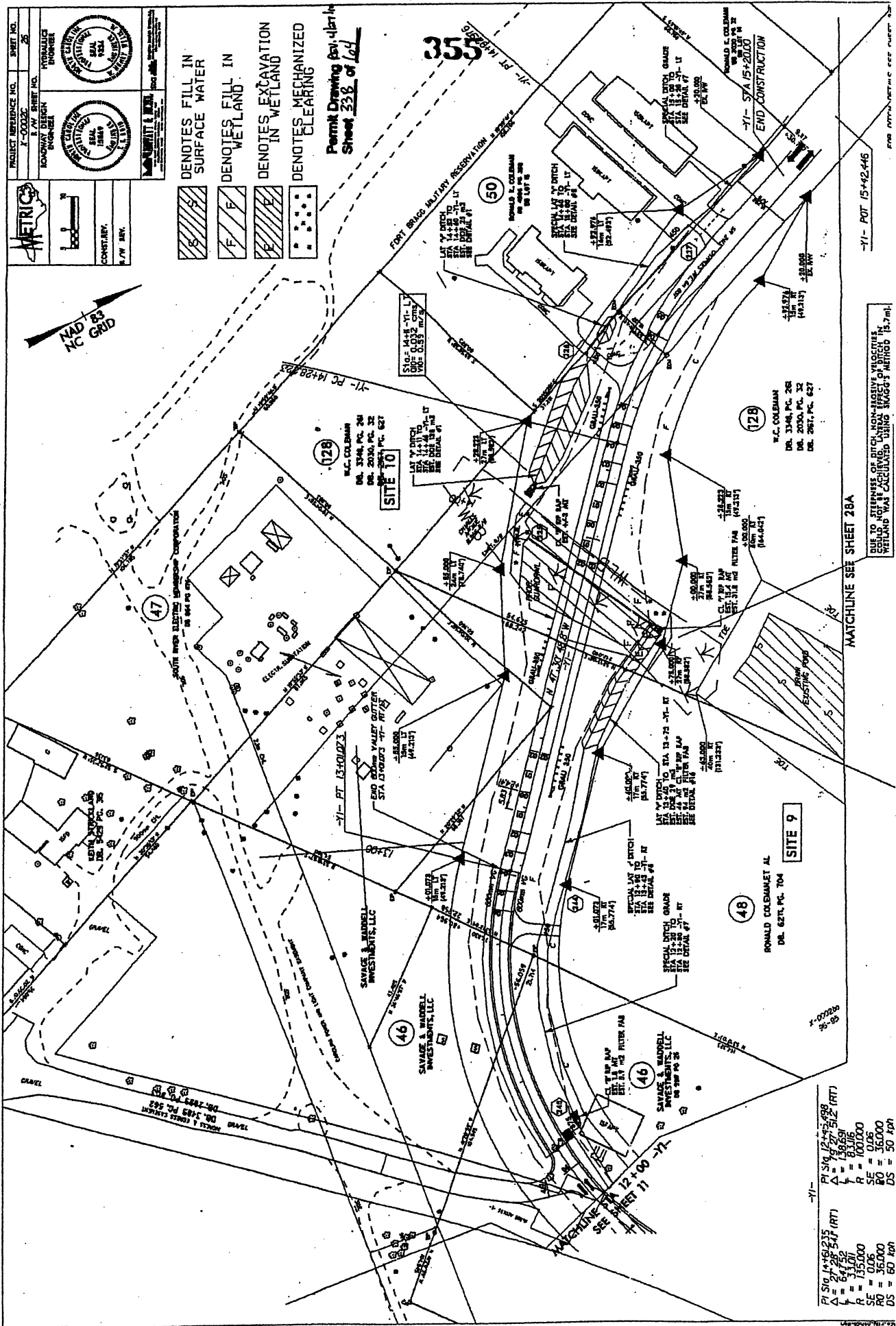
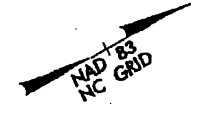

MATCHLINE SEE SHEET 28A

DUPLICATE TO PROPERTY OF DITCH, NON-INGESTIVE VEGEATION COLLECTED. UTMAL EFFECT OF DITCH, VEGETATION WILL BE COLLECTED USING AUGER METHOD (15.7 mi.)

7-0000C
 95-026

PI	510.14+89.235
Δ	2.726
L	130.250
R	100.000
SE	0.05
PO	36.000
DS	60.000

7-0000C
 95-026

PI	510.14+89.235
Δ	2.726
L	130.250
R	100.000
SE	0.05
PO	36.000
DS	60.000

PROJECT REFERENCE NO. 14-000000	SHEET NO. 358
DATE 11/15/11	SCALE AS SHOWN
DESIGNER METRIC ENGINEERING	CHECKED METRIC ENGINEERING
APPROVED METRIC ENGINEERING	DATE 11/15/11

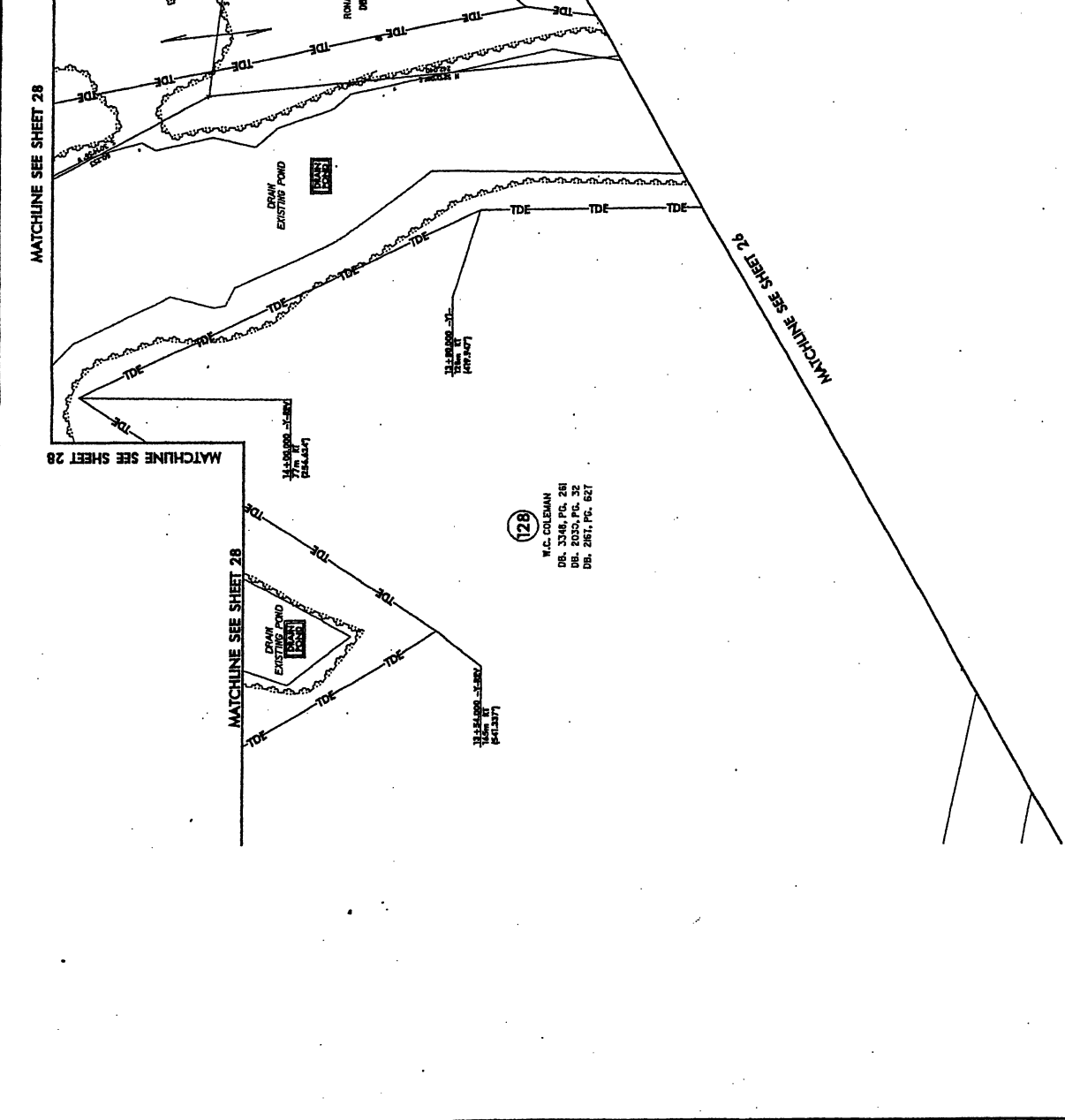

(48)
RONALD COLEMAN AL.
DB. 8216, PG. 704

(128)
W.C. COLEMAN
DB. 3386, PG. 281
DB. 3603, PG. 282
DB. 2867, PG. 287

MATCHLINE SEE SHEET 28

MATCHLINE SEE SHEET 28

MATCHLINE SEE SHEET 28

SEE SHEET 11

MATCHLINE SEE SHEET 28

DRAIN EXISTING POND
POND 1

DRAIN EXISTING POND
POND 2

11-34-000-31
12-28-11
(47-147)

11-34-000-31
12-28-11
(47-147)

11-34-000-31
12-28-11
(47-147)

DRAIN EXISTING POND
POND 3

PERMITS (WHITE SHEETS)..... 225-359

STANDARD SPECIAL PROVISIONS (YELLOW SHEETS)

Availability of Funds – Termination of Contracts.....	1
General Seed Specification for Seed Quality.....	2-4
Errata.....	5
Plant and Pest Quarantines.....	6
Award of Contract.....	7
Minority and Female Employment Requirements.....	8-10
Required Contract Provisions Federal-Aid Construction Contracts.....	11-19
On the Job Training.....	20-22
Wage Rates.....	23-25

PROPOSAL ITEM SHEET AND SIGNATURE SHEET

Item Sheet (s)

Signature Sheet (Bid Acceptance by Department)